

NOTICE
 THIS DRAWING CONTAINS A PROPRIETARY DESIGN ASSIGNED TO SPIRA INTERNATIONAL, INC. ALL RIGHTS TO DUPLICATE, TRANSFER OR SELL THIS DESIGN ARE EXPRESSLY RESERVED. THE BUYER IS LICENSED TO BUILD ONE ASSEMBLY FROM THESE PLANS.

REVISIONS				
ZONE	LTR	DESCRIPTION	DATE	APPROVED
	A	UPDATED TO NEW FORMAT	09/12/08	JJS

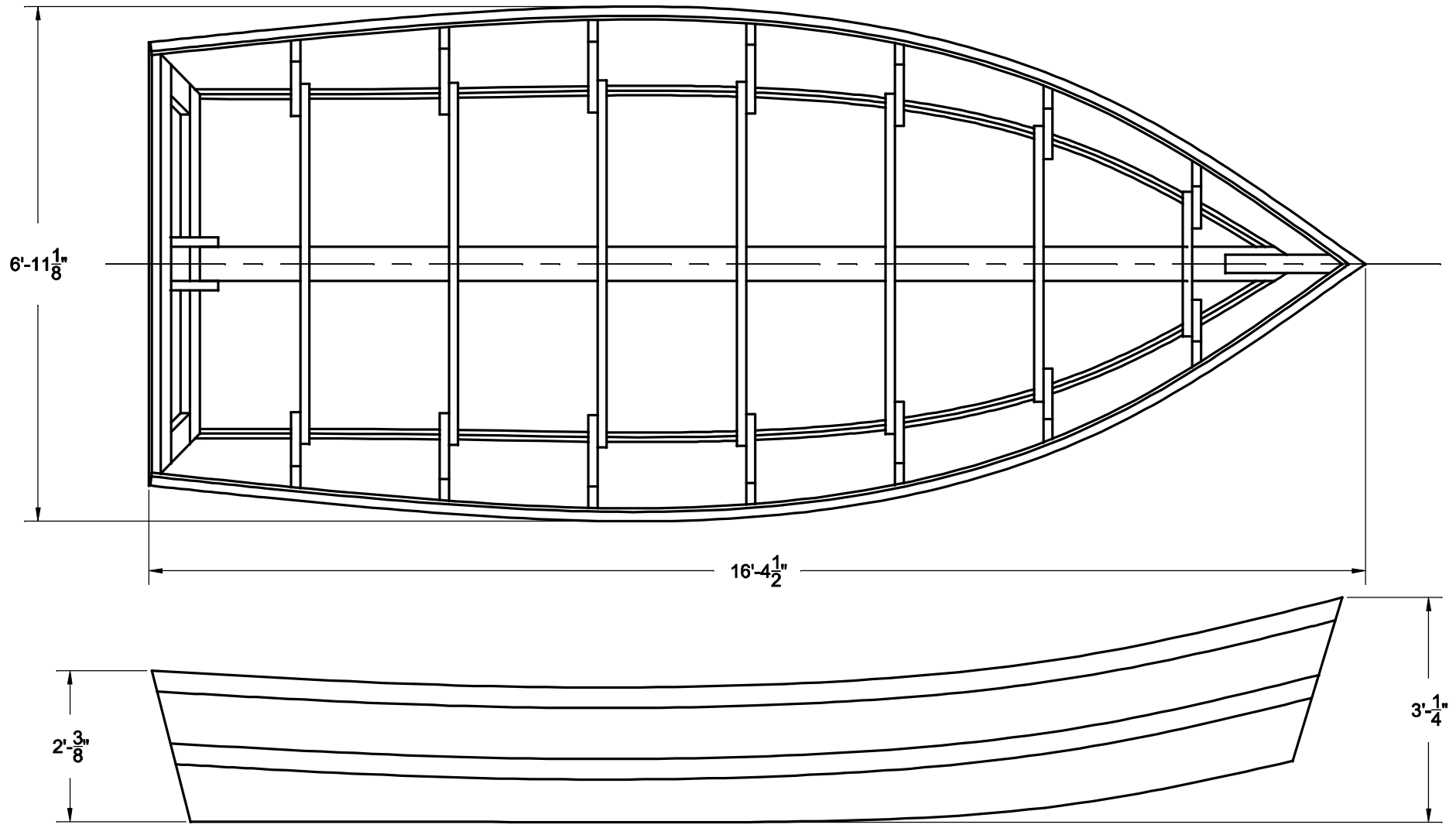

Spira International, Inc.
 Huntington Beach, California

TILLAMOOK
 16' PACIFIC POWER DORY

DRAWN BY: J. SPIRA	DATE: 09/28/07	DRAWING NO. TILL01
SCALE 1" = 1'		SHEET OF

NOTICE
 THIS DRAWING CONTAINS A PROPRIETARY DESIGN ASSIGNED TO SPIRA INTERNATIONAL, INC. ALL RIGHTS TO DUPLICATE, TRANSFER OR SELL THIS DESIGN ARE EXPRESSLY RESERVED. THE BUYER IS LICENSED TO BUILD ONE ASSEMBLY FROM THESE PLANS.

REVISIONS				
ZONE	LTR	DESCRIPTION	DATE	APPROVED
	A	UPDATED TO NEW FORMAT	09/12/08	JJS

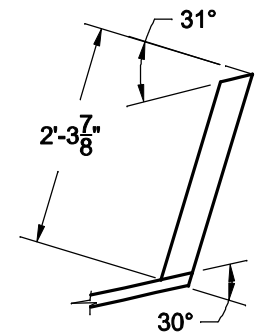
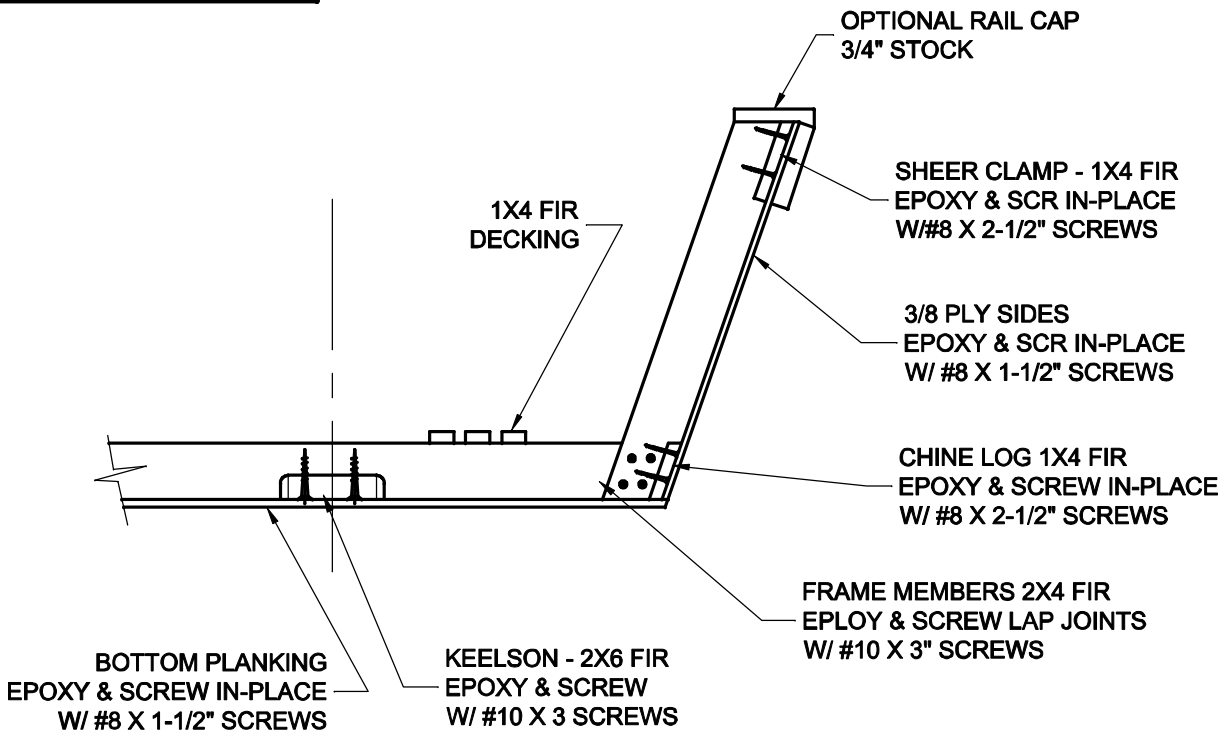

STEM DETAIL
 MAKE FROM 2X4 FIR

TYPICAL CONSTRUCTION METHOD
 ALL FRAME STATIONS
 SCALE 2" = 1'

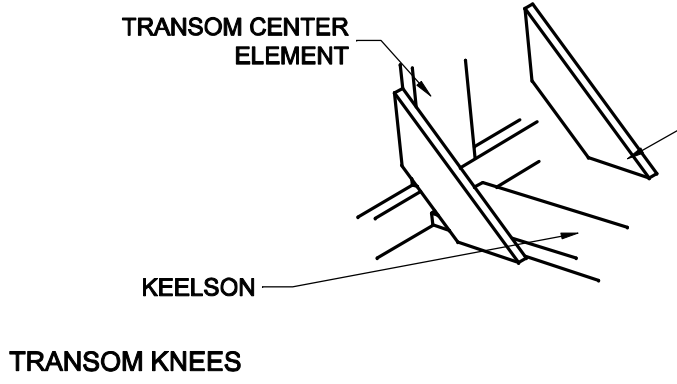
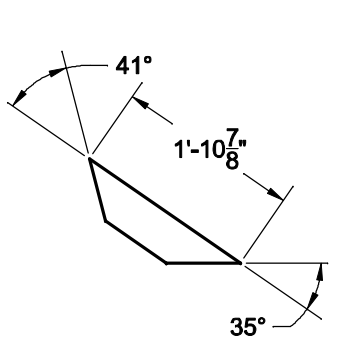

TRANSOM KNEES

Spira International, Inc. <i>Huntington Beach, California</i>		
TILLAMOOK 16' PACIFIC POWER DORY		
DRAWN BY: J. SPIRA	DATE: 09/28/07	DRAWING NO. TILL04
SCALE 1" = 1'		SHEET OF